

LEGEND

- ◇----- ORIGINAL GOVERNMENT CORNER SEARCHED FOR - NOT FOUND
- ◆----- ORIGINAL GOVERNMENT CORNER FOUND
- ◇----- FOREST SERVICE CORNER
- ◆----- STANDARD B.L.M. CORNER
- ◇----- STANDARD D.W.R. CORNER
- ◆----- STANDARD BUTTE CORNER - 2" IRON PIPE AND BRASS CAP
- CORNER MONUMENT - NO HISTORY - SHOWN ON RECORD MAP
- CORNER MONUMENT - NO HISTORY
- ORIGINAL CORNER MONUMENT - SHOWN ON RECORD MAP
- PROPORTIONED CORNER SET BY SURVEYOR - SHOWN ON RECORD MAP
- CORNER MONUMENT SET BY SURVEYOR - NOT SHOWN ON RECORD MAP
- CORNER SEARCHED FOR NOT FOUND - DATE OF SEARCH
-
-
-
-

NOTES

- 32-PM-25 ----- BOOK 32 OF PARCEL MAPS PAGE 25
- 32-RS-25 ----- BOOK 32 OF RECORD OF SURVEY MAPS PAGE 25
- 32-S-25 ----- BOOK 32 OF MAPS (SUBDIVISION) PAGE 25
- 114-FB-25 ----- BOOK 114 PAGE 25 OF COUNTY SURVEY FIELD NOTES
- C-506 ----- MAP ON FILE PUBLIC WORKS DEPARTMENT
- CR ----- CORNER RECORD FILED
- PS ----- PRIVATE SURVEYORS INFORMATION
- M.O.R. ----- MOUND OF ROCKS

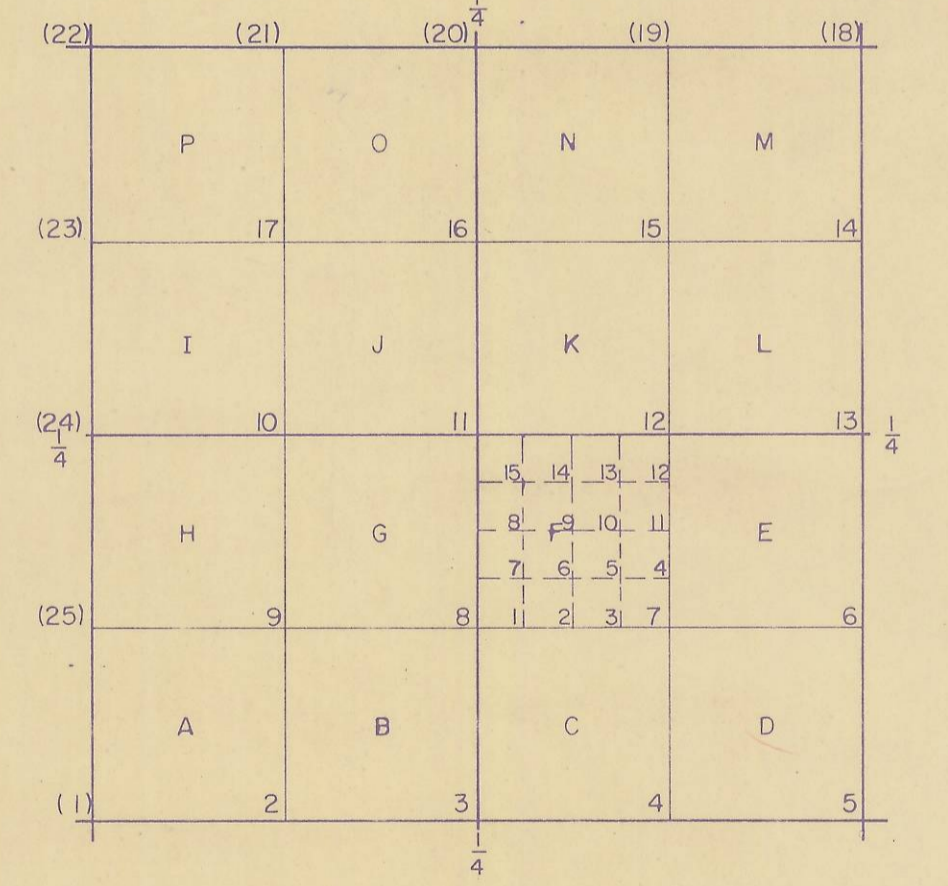
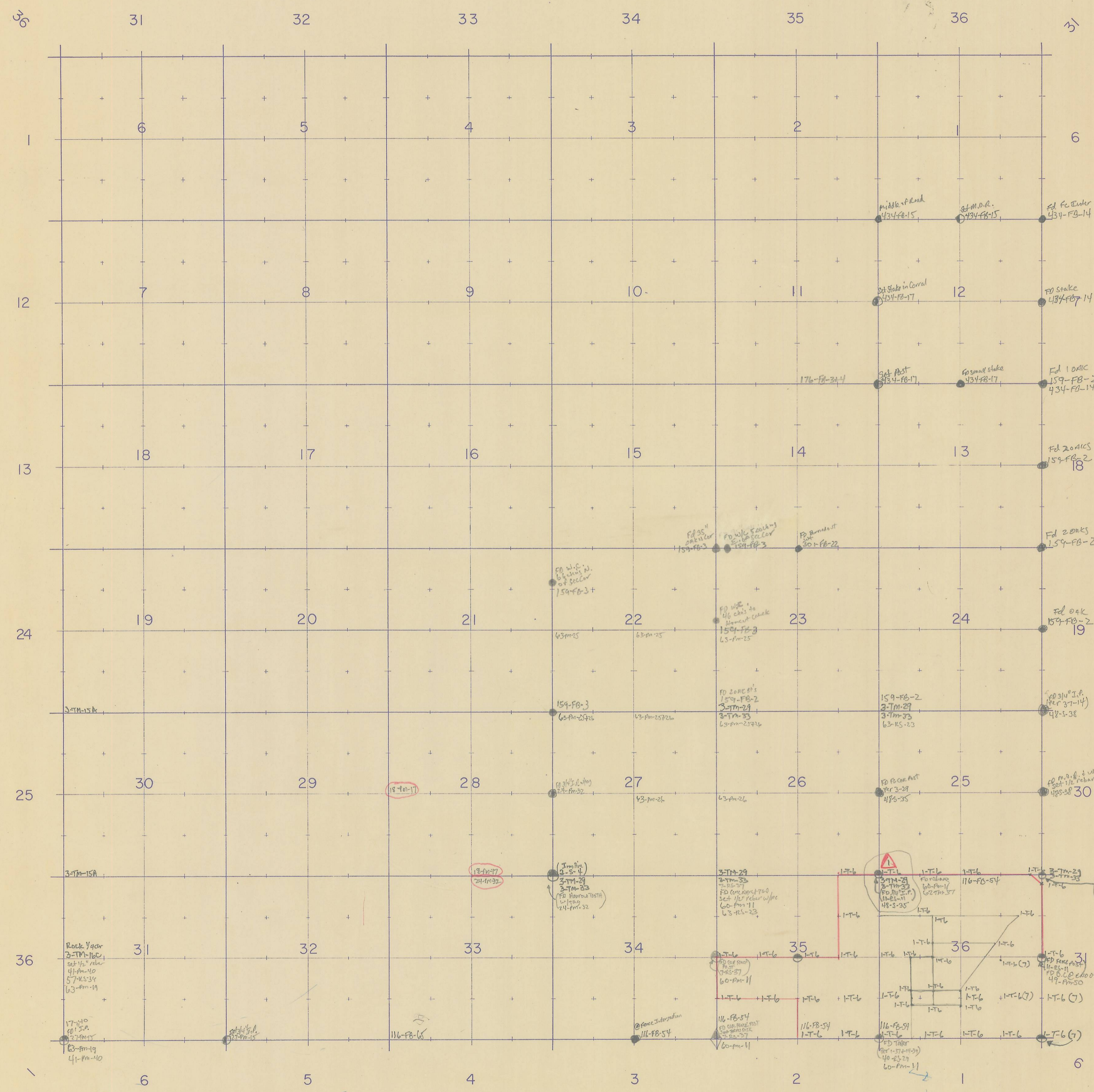

Section Corner Index Typical
 () - Special case
 EXAMPLE:
 18-3 = South 1/4 corner of Section 18
 18-F-9 = Center of NW 1/4 of SE 1/4 of Section 18

△ Ed Brass Cap in wall replaced 3/4/54.
 60-PM-11
 62-TM-37
 63-R1-L3

COUNTY OF YUBA
 DEPARTMENT OF PUBLIC WORKS
 MARYSVILLE CALIFORNIA

Section Corner Monumentation
 T. 17 N. - R. 4 E. - M.D.B. & M.

DWN. BY	DATE	PROJECT NUMBER
CHK. BY	DATE	
F.B.	SCALE 1" = 2000'	

Date of last entry _____